

WARATAH ROAD

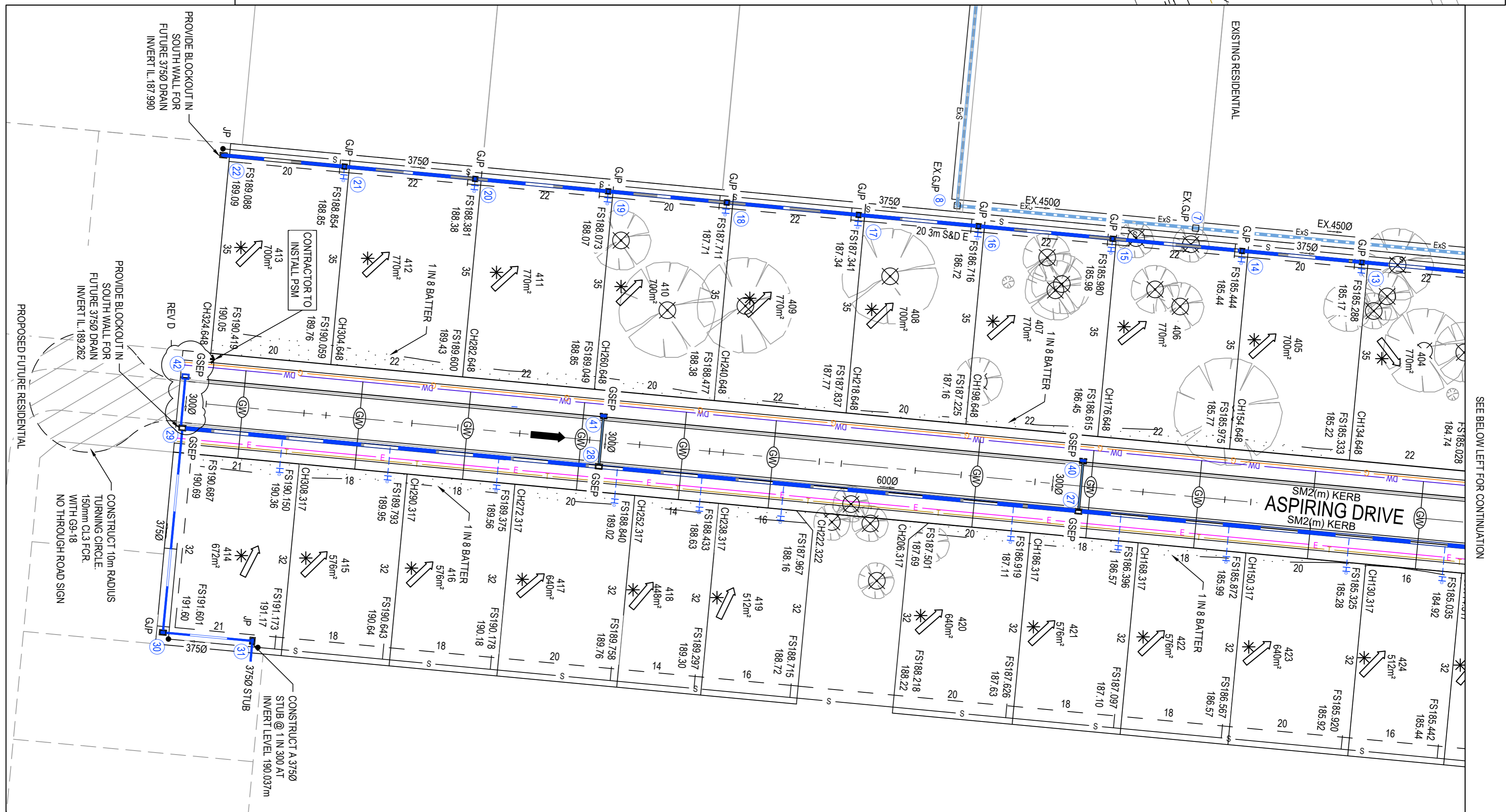

ROAD NAME	GAS		WATER		ELECTRICITY		TELSTRA	
	SIDE	OFFSET (m)	SIDE	OFFSET (m)	SIDE	OFFSET (m)	SIDE	OFFSET (m)
ASPIRING DRIVE	WEST	1.90	WEST	2.40	EAST	2.40	EAST	1.90



- LEGEND - LAYOUT PLAN**
- SWALE DRAIN
 - EXISTING STORMWATER DRAIN & PITS
 - STORMWATER DRAIN, PIT & PROPERTY INLET
 - HOUSE DRAIN
 - SEWER & MAINTENANCE STRUCTURES
 - SERVICE CONDUITS
 - TRAFFIC PAVERS (INDICATIVE ONLY)
 - ELECTRICITY (UNDERGROUND)
 - ELECTRICITY (OVERHEAD)
 - OPTIC FIBRE
 - TELECOMMUNICATIONS
 - GAS
 - WATER
 - RECYCLED WATER
 - EXISTING ELECTRICITY (UNDERGROUND)
 - EXISTING ELECTRICITY (OVERHEAD)
 - EXISTING GAS
 - EXISTING TELECOMMUNICATIONS
 - EXISTING WATER
 - EXISTING RECYCLED WATER
 - EXISTING STORMWATER DRAIN
 - EXISTING HOUSE DRAIN
 - EXISTING SURFACE LEVEL
 - FINISHED BUILDING LINE LEVEL
 - TOP OF RETAINING WALL
 - BOTTOM OF RETAINING WALL
 - RIDGE LINE
 - RETAINING WALL
 - ZERO LOT LINES
 - PAVEMENT TREATMENT
 - EX STRUCTURAL FILL > 200mm DEEP
 - EX STRUCTURAL FILL > 200mm DEEP
 - DIRECTION OF FLOW
 - OVERLAND FLOW
 - ALLOCATION TO BE GRADED EVENLY IN DIRECTION OF FLOW TO LEVELS INDICATED
 - CONCRETE EDGE STRIP WITH SUBSOIL DRAIN, NO ROAD SIGN & BARRIER
 - LIMIT OF WORKS
 - EXISTING TREE TO BE REMOVED
 - PERMANENT SURVEY MARK
 - TEMPORARY BENCH MARK
 - STAGE BOUNDARY

WARNING
 BEWARE OF UNDERGROUND SERVICES
 The locations of underground services are approximate only and their exact position should be proven on site. No guarantee is given that all existing services are shown. Locate all underground services before commencement of works.
DIAL 1100 BEFORE YOU DIG
 www.1100.com.au

© COPYRIGHT All rights reserved
 Beveridge Williams & Co. Pty Ltd has granted a license to use this document for its intended purpose.
 No unauthorised copying is permitted.

Rev	Issue	Date	By	Check
A	CONSTRUCTION ISSUE	17.02.2019	AW JS	JS
P1	AMENDMENTS AS PER COUNCIL COMMENTS	20.02.2019	AW JS	JS
P2	AMENDMENTS AS PER COUNCIL COMMENTS	13.02.2019	AW JS	JS
P3	AMENDMENTS AS PER COUNCIL COMMENTS	08.02.2019	AW JS	JS
P4	AMENDMENTS AS PER COUNCIL COMMENTS	21.02.2019	AW JS	JS
P5	ISSUED FOR APPROVAL	21.02.2019	AW JS	JS

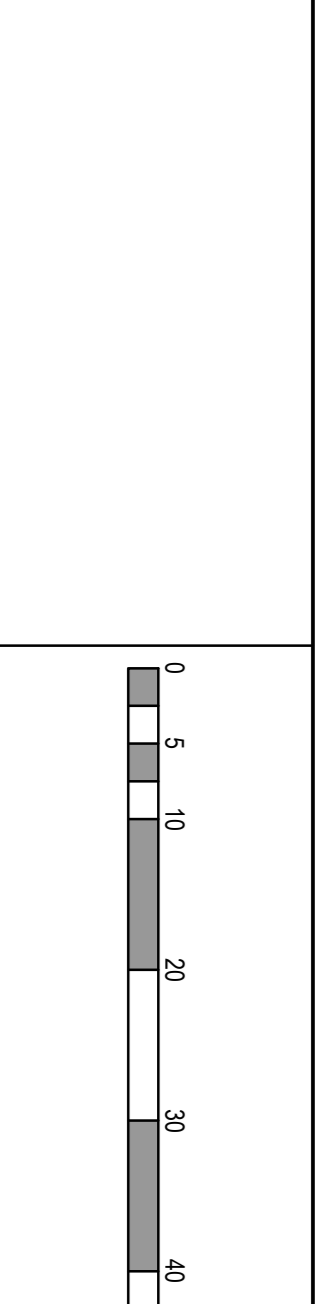

Designed: A WILTSHIRE
 Date: 14.02.2019

Drawn: A WILTSHIRE
 Date: 26.05.2019

Approved: LSPARK
 Date: 26.05.2019

PS Number: PS918524E

Beveridge Williams
 development & environment consultants
 96 Main Road
 Ballarat VIC 3350
 ph: 03 5327 2000
 www.beveridgewilliams.com.au

Project Details
VIEWPOINT ESTATE
INTEGRA PTY LTD
CITY OF GREATER BENDIGO

Drawing Title
LAYOUT PLAN

Scale
1:500 @ A1

Sheet **03 of 13**

Project Ref: **1702011 E2**

Drawn No: **010**

Rev: **D**

This plan is provided for marketing and information purposes only. It shows design levels only which may change during construction. Builders should check all information prior to the building process. Where discrepancies exist between the plan of subdivision and this plan, the plan of subdivision shall be taken as correct. It is the responsibility of the prospective purchaser to confirm prior to purchase, all lot levels, fill depth and all service locations are correct.