

NOTE:
 ANY USE OF THE ELECTRONIC DRAWINGS OR DATA PROVIDED BY CardnoTGM SHALL BE USED AT THE USER'S RISK. NO RESPONSIBILITY WILL BE TAKEN BY CardnoTGM AS TO THE ACCURACY OF THE DIGITAL DRAWING OR DATA. ANY SET OUT WORKS UNDERTAKEN USING CardnoTGM DIGITAL DRAWINGS OR DATA SHOULD BE CHECKED AGAINST EXISTING TITLE PEGS. TEMPORARY AND/OR PERMANENT SURVEY MARKS AS NOMINATED BY THE PROJECTS LICENSED SURVEYOR, THE SET-OUT INFORMATION PROVIDED ON ARCHITECTURAL AND/OR OTHER PROJECT RELATED DRAWINGS AND DOCUMENTS, IN CONJUNCTION WITH THE APPROVED HARD COPY DRAWINGS PRIOR TO THE COMMENCEMENT OF CONSTRUCTION

NOTE:
 ALL SIGNS & LINEMARKING TO BE INSTALLED IN ACCORDANCE WITH VICROADS TRAFFIC ENGINEERING MANUAL VOLUME 2 - SIGNS & MARKINGS.

LEGEND

- DESIGN / EXISTING SURFACE CONTOURS
- PROPOSED STORM WATER DRAINAGE PIPE & PIT
- PROPOSED SEWER MAIN ALIGNMENT & PIT. (IN ACCORDANCE WITH CHW DESIGN DOCUMENTS)
- PROPOSED TELSTRA
- PROPOSED POWER
- PROPOSED WATER MAIN
- PROPOSED GAS MAIN
- PROPOSED AGI DRAIN
- EXISTING SEWER MAIN ALIGNMENT & PIT
- EXISTING TELSTRA
- EXISTING WATER MAIN
- EXISTING GAS MAIN
- EXISTING KERB & CHANNEL
- EXISTING STORMWATER DRAINAGE PIPE/PIT
- EXISTING TABLE DRAIN
- PROPOSED TITLE BOUNDARY
- PROPOSED EASEMENT
- PROPOSED ROAD KERB & CHANNEL (NO. 2 BARRIER KERB)
- PROPOSED ROAD CENTRELINE
- PROPOSED HOUSE DRAIN CONNECTION & PROPERTY INLET PIT: (P) PIPE-(K) KERB
- LOT 20 FALL
- TEMPORARY BENCH MARK
- PROPOSED FOOTPATH
- EXTENT OF PROPOSED ROAD PAVEMENT
- EXTENT OF TEMPORARY TURNING AREA
- PROPOSED POWER PIT

NOTE:
 ALL DISTURBED SURFACES, FENCING & OTHER ITEMS TO BE RE-INSTATED TO ORIGINAL CONDITION.

NOTE: CONTRACTOR IS TO BE AWARE OF THE LOCALISED LOWERING OF SERVICES INFRASTRUCTURE TO PROVIDE MINIMUM CLEARANCES TO EXISTING AND PROPOSED INFRASTRUCTURE. LOCALISED LOCATIONS ARE INDICATED BASED ON ANTICIPATED SERVICE INFRASTRUCTURE ALIGNMENTS AND SHOULD BE CONSIDERED BY THE CONTRACTOR WHEN PRICING.

PLAN VIEW
 SCALE 1:500

ISSUE	ISSUED FOR	DATE	DRAWN	APPROVED	ISSUE	ISSUED FOR	DATE	DRAWN	APPROVED	DESIGNED	DATE	SCALE
01	PRELIMINARY	22/01/2021	J.H.	R.D.						S.LOTAY	SEP 2020	AS SHOWN
02	PRELIMINARY	01/02/2021	R.J.F.	R.D.						J. HADFIELD		A1
										CARDNO TGM		

Cardno TGM
 ABN 11 125 568 461
 1315 Sturt Street, Ballarat, VIC Australia (PO Box 563W, Ballarat West) 3350
 Phone +61 3 5330 8888 Fax +61 3 5333 2815
 Email: victoria@cardno.com.au Web: www.cardno.com

Integra

LUCAS ESTATE
 RESIDENTIAL SUBDIVISION
 STAGE M2 (27 LOTS)

CIVIL DRAWING	
DRAWING TITLE: ROAD AND SIGNAGE LAYOUT PLAN	
REF No: 18775-207	SHEET C02 OF 13 REV 02

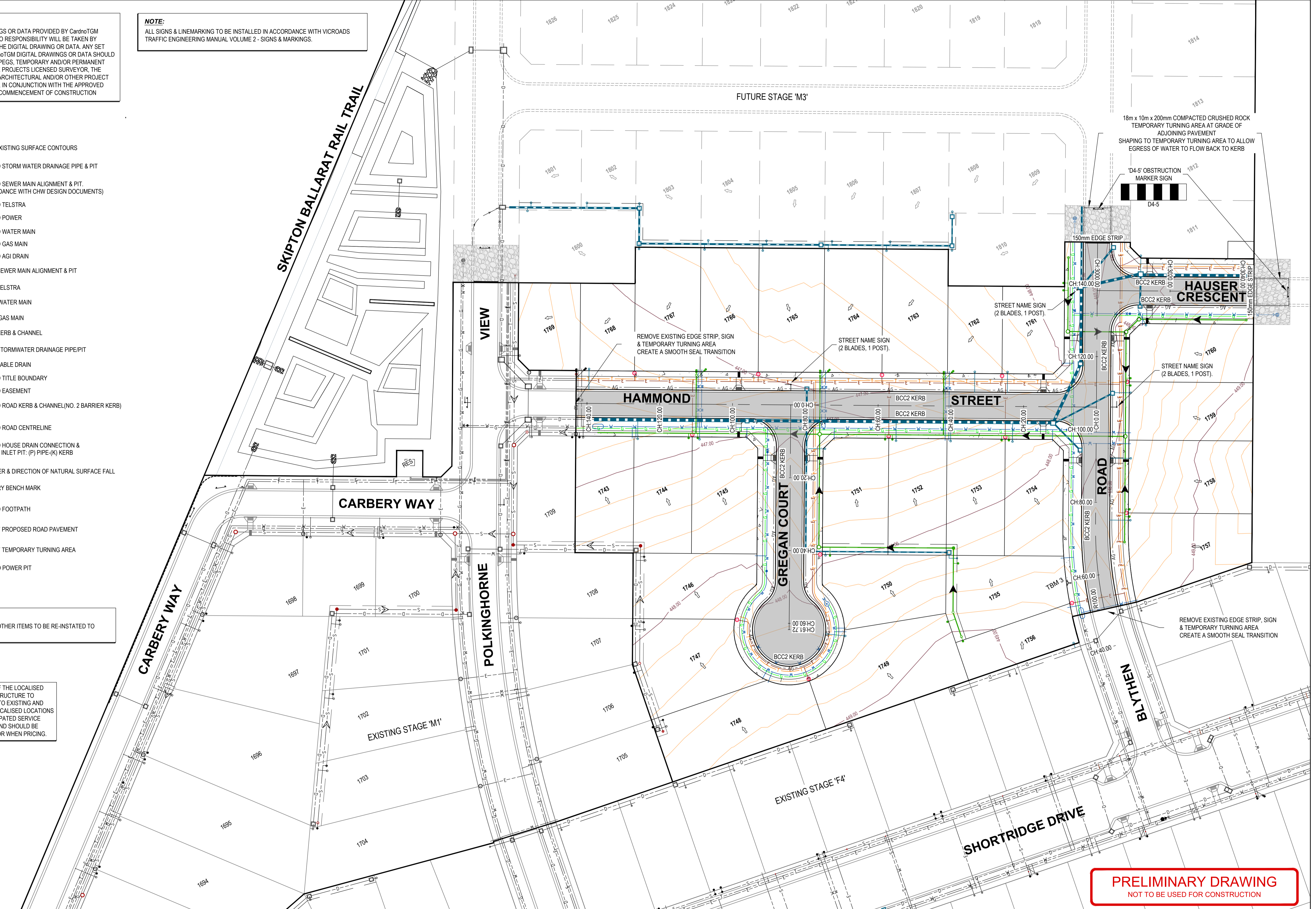

PRELIMINARY DRAWING
 NOT TO BE USED FOR CONSTRUCTION

NOTE:
 ANY USE OF THE ELECTRONIC DRAWINGS OR DATA PROVIDED BY CardnoTGM SHALL BE USED AT THE USER'S RISK. NO RESPONSIBILITY WILL BE TAKEN BY CardnoTGM AS TO THE ACCURACY OF THE DIGITAL DRAWING OR DATA. ANY SET OUT WORKS UNDERTAKEN USING CardnoTGM DIGITAL DRAWINGS OR DATA SHOULD BE CHECKED AGAINST EXISTING TITLE PEGS. TEMPORARY AND/OR PERMANENT SURVEY MARKS AS NOMINATED BY THE PROJECTS LICENSED SURVEYOR, THE SET-OUT INFORMATION PROVIDED ON ARCHITECTURAL AND/OR OTHER PROJECT RELATED DRAWINGS AND DOCUMENTS, IN CONJUNCTION WITH THE APPROVED HARD COPY DRAWINGS PRIOR TO THE COMMENCEMENT OF CONSTRUCTION

LEGEND

- DESIGN / EXISTING SURFACE CONTOURS
- PROPOSED STORM WATER DRAINAGE PIPE & PIT
- PROPOSED SEWER MAIN ALIGNMENT & PIT. (IN ACCORDANCE WITH CHW DESIGN DOCUMENTS)
- PROPOSED TELSTRA
- PROPOSED POWER
- PROPOSED WATER MAIN
- PROPOSED GAS MAIN
- EXISTING SEWER MAIN ALIGNMENT & PIT
- EXISTING TELSTRA
- EXISTING WATER MAIN
- EXISTING GAS MAIN
- EXISTING KERB & CHANNEL
- EXISTING STORMWATER DRAINAGE PIPE/PIT
- EXISTING TABLE DRAIN
- PROPOSED TITLE BOUNDARY
- PROPOSED EASEMENT
- PROPOSED AGI DRAIN
- PROPOSED ROAD KERB & CHANNEL (NO. 2 BARRIER KERB)
- PROPOSED ROAD CENTRELINE
- PROPOSED ENDWALL & ROCK BEACHING
- PROPOSED HOUSE DRAIN CONNECTION & PROPERTY INLET PIT. (P) PIPE-(K) KERB
- LOT NUMBER & DIRECTION OF NATURAL SURFACE FALL
- TEMPORARY BENCH MARK
- PERMANENT SURVEY MARK
- PROPOSED FOOTPATH
- EXTENT OF PROPOSED ROAD PAVEMENT
- PROPOSED POWER PIT
- PROPOSED PIT NUMBER AND TYPE

NOTE:
 THE ORIENTATION OF ALL STORMWATER DRAINAGE ACCESS COVERS & GRATES ARE SHOWN INDICATIVELY AND ARE TO BE MANUFACTURED & INSTALLED IN ACCORDANCE WITH AS3996-2006.

NOTE:
 ALTERNATIVE PIPE MATERIAL CAN BE UTILISED PROVIDING THEY MEET THE REQUIRED LOAD, SPECIFICATIONS & AUTHORITY REQUIREMENTS.

NOTE:
 CONTRACTOR IS TO BE AWARE OF THE LOCALISED LOWERING OF SERVICES INFRASTRUCTURE TO PROVIDE MINIMUM CLEARANCES TO EXISTING AND PROPOSED INFRASTRUCTURE. LOCALISED LOCATIONS ARE INDICATED BASED ON ANTICIPATED SERVICE INFRASTRUCTURE ALIGNMENTS AND SHOULD BE CONSIDERED BY THE CONTRACTOR WHEN PRICING.

NOTE:
 ALL DISTURBED SURFACES, FENCING & OTHER ITEMS TO BE RE-INSTATED TO ORIGINAL CONDITION.

NOTE:
 THE LOCATION OF EXISTING UNDERGROUND SERVICES ARE SHOWN INDICATIVELY ONLY. THE CONTRACTOR IS RESPONSIBLE FOR CONTACTING ALL AUTHORITIES TO DETERMINE THE LOCATION OF UNDERGROUND SERVICES PRIOR TO THE COMMENCEMENT OF CONSTRUCTION WORK. ANY CLASH OF WORKS WITH A SERVICE IS TO BE REPORTED TO THE ENGINEER IMMEDIATELY. THE CONTRACTOR SHALL ENSURE THAT ALL SERVICES ARE FULLY PROTECTED DURING CONSTRUCTION. ANY SERVICES DAMAGED DURING CONSTRUCTION SHALL BE REPAIRED AT THE CONTRACTORS EXPENSE.

NOTE:
 ALL DRAINAGE STUB PIPES TO INSTALL FORM PLY CAPPING OR SIMILAR.

NOTE:
 ALL STORMWATER HOUSE CONNECTIONS TO PROPOSED UNDERGROUND DRAINAGE ARE TO BE CONNECTED ABOVE SPRINGLINE OF PIPE AND GRADED INTO PROPERTY AT 1 IN 100 AND BROUGHT TO SURFACE WITH RISER & CAP.

NOTE:
 ALL DISTURBED SURFACES, FENCING & OTHER ITEMS TO BE RE-INSTATED TO ORIGINAL CONDITION.

NOTE:
 CONTRACTOR IS TO BE AWARE OF THE LOCALISED LOWERING OF SERVICES INFRASTRUCTURE TO PROVIDE MINIMUM CLEARANCES TO EXISTING AND PROPOSED INFRASTRUCTURE. LOCALISED LOCATIONS ARE INDICATED BASED ON ANTICIPATED SERVICE INFRASTRUCTURE ALIGNMENTS AND SHOULD BE CONSIDERED BY THE CONTRACTOR WHEN PRICING.

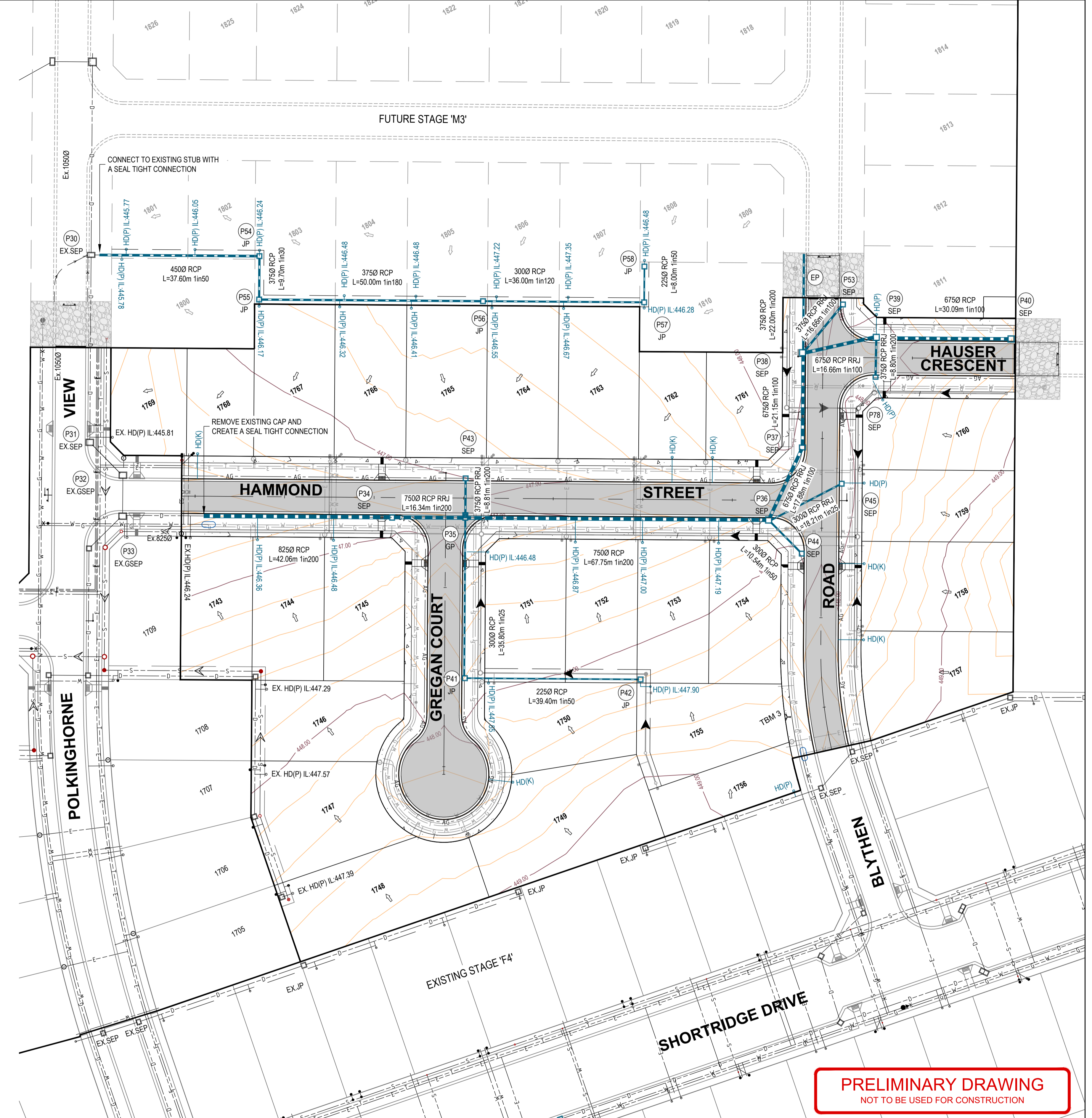

PLAN VIEW
 SCALE 1:500

PRELIMINARY DRAWING
 NOT TO BE USED FOR CONSTRUCTION

ISSUE	ISSUED FOR	DATE	DRAWN	APPROVED	ISSUE	ISSUED FOR	DATE	DRAWN	APPROVED
01	PRELIMINARY	22/01/2021	J.H.	R.D.					
02	PRELIMINARY	01/02/2021	R.J.F.	R.D.					

DESIGNED: S.LOTAY	DATE: SEP 2020
DRAWN: J.HADFIELD	SCALE: AS SHOWN
SURVEY: CARDNO TGM	SHEET SIZE: A1
CHECKED:	APPROVED:
DATE:	DATE:

Cardno TGM
 ABN 11 125 568 461
 1315 Sturt Street, Ballarat, VIC Australia (PO Box 563W, Ballarat West) 3350
 Phone +61 3 5330 8898 Fax +61 3 5333 9815
 Email: victoria@cardno.com.au Web: www.cardno.com

Integra

LUCAS ESTATE
 RESIDENTIAL SUBDIVISION
 STAGE M2 (27 LOTS)

CIVIL DRAWING	
DRAWING TITLE: DRAINAGE LAYOUT PLAN	
REF No: 18775-207	SHEET C03 OF 13 REV 02

NOTE:
 ANY USE OF THE ELECTRONIC DRAWINGS OR DATA PROVIDED BY CardnoTGM SHALL BE USED AT THE USER'S RISK. NO RESPONSIBILITY WILL BE TAKEN BY CardnoTGM AS TO THE ACCURACY OF THE DIGITAL DRAWING OR DATA. ANY SET OUT WORKS UNDERTAKEN USING CardnoTGM DIGITAL DRAWINGS OR DATA SHOULD BE CHECKED AGAINST EXISTING TITLE PEGS. TEMPORARY AND/OR PERMANENT SURVEY MARKS AS NOMINATED BY THE PROJECTS LICENSED SURVEYOR, THE SET-OUT INFORMATION PROVIDED ON ARCHITECTURAL AND/OR OTHER PROJECT RELATED DRAWINGS AND DOCUMENTS, IN CONJUNCTION WITH THE APPROVED HARD COPY DRAWINGS PRIOR TO THE COMMENCEMENT OF CONSTRUCTION

LEGEND

- FS ????.?? FINISHED SURFACE LEVEL
- ES ????.?? EXISTING SURFACE LEVEL
- PROPOSED TITLE BOUNDARY
- PROPOSED EASEMENT
- PROPOSED ROAD KERB & CHANNEL
- EXISTING ROAD AND KERB
- LOT 20 FALL LOT NUMBER & DIRECTION OF NATURAL SURFACE FALL

FILL 0.3m & MORE

COLOUR DEPTH RANGE

0.3 m to 0.4 m	
0.4 m to 0.5 m	
0.5 m to 0.6 m	
0.6 m to 0.7 m	
0.7 m to 0.8 m	
0.8 m to 0.9 m	
0.9 m to 1.0 m	
1.0 m to 2.0 m	
2.0 m to 3.0 m	
3.0 m to 4.0 m	
4.0 m to 5.0 m	
5.0 m to 6.0 m	
6.0 m to 7.0 m	
7.0 m to 8.0 m	
8.0 m to 9.0 m	
9.0 m to 10.0 m	
10.0 m to 1000 m	

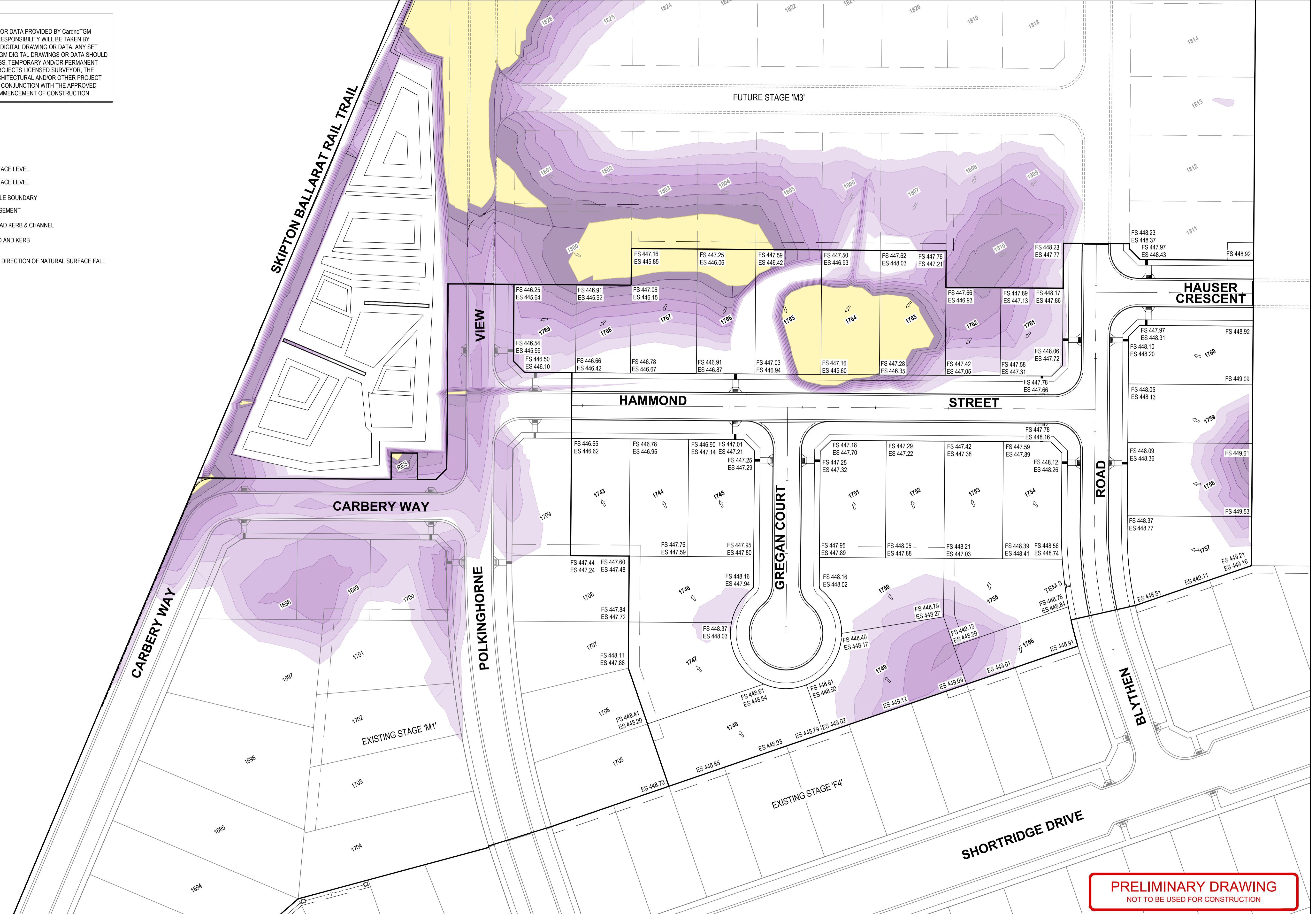

PLAN VIEW
 SCALE 1:500

PRELIMINARY DRAWING
 NOT TO BE USED FOR CONSTRUCTION

ISSUE	ISSUED FOR	DATE	DRAWN	APPROVED	ISSUE	ISSUED FOR	DATE	DRAWN	APPROVED	DESIGNED	DATE
01	PRELIMINARY	22/01/2021	J.H.	R.D.						S.LOTAY	SEP 2020
02	PRELIMINARY	01/02/2021	R.J.F.	R.D.						J. HADFIELD	AS SHOWN
										CARDNO TGM	A1

ABN 11 125 568 461
 1315 Sturt Street, Ballarat, VIC Australia (PO Box 563W, Ballarat West) 3350
 Phone +61 3 5330 8888 Fax +61 3 5333 9915
 Email: victoria@cardno.com.au Web: www.cardno.com

CLIENT: LUCAS ESTATE
 PROJECT: RESIDENTIAL SUBDIVISION
 STAGE M2 (27 LOTS)

CIVIL DRAWING	
DRAWING TITLE: LOT LEVELS & ABOVE 300mm FILL LAYOUT PLAN	
REF No: 18775-207	SHEET C04 OF 13 REV 02

This plan is provided for marketing and information purposes only, it shows design levels only which may change during construction. Builders should check all information prior to the building process. Where discrepancies exist between the plan of subdivision and this plan, the plan of subdivision shall be taken as correct. It is the responsibility of the prospective purchaser to confirm prior to purchase, all lot levels, fill depth and all service locations are correct.