

**NOTE:**  
 ANY USE OF THE ELECTRONIC DRAWINGS OR DATA PROVIDED BY CardnoTGM SHALL BE USED AT THE USER'S RISK. NO RESPONSIBILITY WILL BE TAKEN BY CardnoTGM AS TO THE ACCURACY OF THE DIGITAL DRAWING OR DATA. ANY SET OUT WORKS UNDERTAKEN USING CardnoTGM DIGITAL DRAWINGS OR DATA SHOULD BE CHECKED AGAINST EXISTING TITLE PEGS. TEMPORARY AND/OR PERMANENT SURVEY MARKS AS NOMINATED BY THE PROJECT'S LICENSED SURVEYOR, OR THE SET-OUT INFORMATION PROVIDED ON ARCHITECTURAL AND/OR OTHER PROJECT RELATED DRAWINGS AND DOCUMENTS, IN CONJUNCTION WITH THE APPROVED HARD COPY DRAWINGS PRIOR TO THE COMMENCEMENT OF CONSTRUCTION.

**LEGEND**

FS ????.?? FINISHED SURFACE LEVEL  
 ES ????.?? EXISTING SURFACE LEVEL  
 - - - - - PROPOSED TITLE BOUNDARY  
 - - - - - PROPOSED EASEMENT  
 = = = = = PROPOSED ROAD KERB & CHANNEL  
 - - - - - EXISTING ROAD AND KERB  
 LOT 20  $\searrow$  FALL LOT NUMBER & DIRECTION OF NATURAL SURFACE FALL

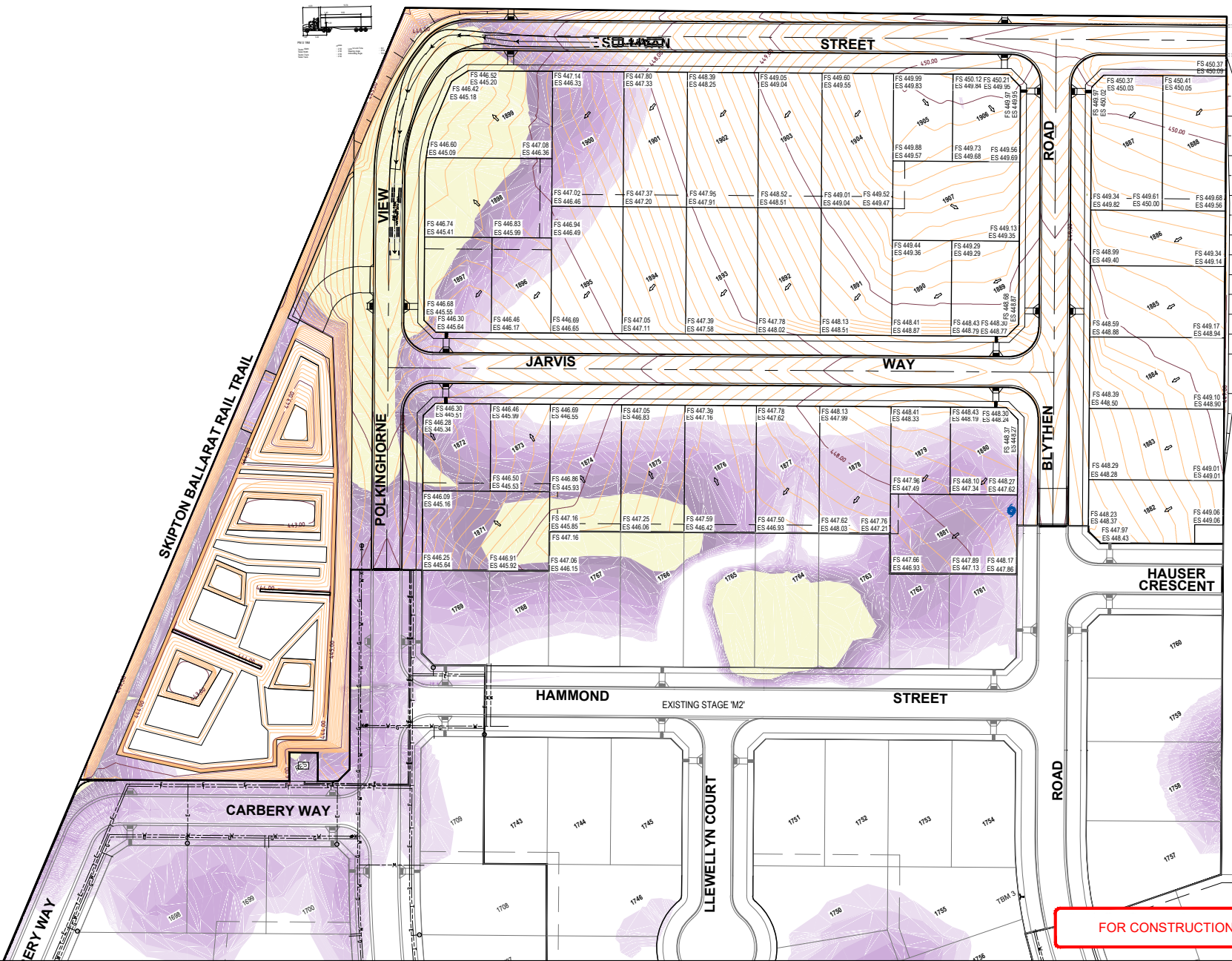
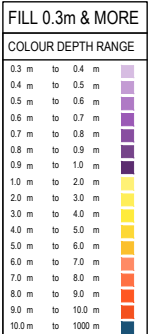

FOR CONSTRUCTION

**PLAN VIEW**  
 SCALE 1:500

ISSUE	ISSUED FOR	DATE	DRAWN	APPROVED	SCALE	ISSUED FOR	DATE	DRAWN	APPROVED	DESIGNED	S.LOTAY	DATE	SEP 2020
01	PRELIMINARY	22/01/2021	J.R.							DRAWN	J. HADFIELD	DATE	AS SHOWN
02	PRELIMINARY	13/05/2021	R.J.F.							SURVEY	CARDNO TGM	DATE	A1
03	PRELIMINARY	18/05/2021	R.J.F.							CHECKED	R.DUNN	DATE	G. MANSELL
04	APPROVAL	20/05/2021	R.J.F.	R.D.						DATE	20/05/2021	DATE	8/06/2021
05	APPROVAL	28/05/2021	R.J.F.	R.D.									
06	CONSTRUCTION	30/05/2021	J.A.	R.D.									

**LUCAS ESTATE  
 RESIDENTIAL SUBDIVISION  
 STAGE M3 (37 LOTS)**

1315 Short Street, Ballarat, VIC, Australia | P.O. Box 5633W, Ballarat West 3350  
 Phone +61 3 5330 8888 | Fax +61 3 5333 3815  
 Email: info@cardno.com.au | Web: www.cardno.com

**CIVIL DRAWING**

**LOT LEVELS & ABOVE 300mm FILL  
 LAYOUT PLAN**

REF. NO: 18775-207      SHEET: C04 OF 17      REV: 06