

PT	TYPE	PT DIMENSIONS			PT ELEVATIONS		PT LOCATION		FACE BRG	COMMENTS
No.		L	W	D	INVERT	TOP	EASTING	NORTHING	DEG MIN	
E15	SEP	900	1200	2486	434.474	436.940	74652.083	5839544.736	99.52	PROVIDE LADDER. REFER TO SD-P-1
E16	JP	900	900	2.311	434.635	436.946	74653.719	5839542.512	99.52	PROVIDE STEP RONS. REFER TO SD-P-1
E17	SEP	900	900	2.028	434.832	436.860	74659.827	5839546.801	9.52	PROVIDE STEP RONS. REFER TO SD-P-1
E17-2	SEP	900	900	1.607	435.281	436.888	74658.197	5839545.033	189.52	PROVIDE STEP RONS. REFER TO SD-P-1
E17-3	SEP	900	900	1.648	435.679	437.327	74654.089	5839578.335	189.52	PROVIDE STEP RONS. REFER TO SD-P-1
E17-3a	EP	-	-	-	-	-	74654.755	5839582.776	9.52	REFER TO SD-P-1
E17-3S	SEP	900	750	1.482	435.379	436.861	74656.474	5839580.331	279.52	PROVIDE STEP RONS. REFER TO SD-P-1
E18	SEP	900	900	2.339	434.936	437.275	74666.827	5839526.472	99.52	PROVIDE STEP RONS. REFER TO SD-P-1
E19	JP	900	900	2.235	436.235	438.470	74572.386	5839528.694	99.52	PROVIDE STEP RONS. REFER TO SD-P-1
E19-1	SEP	900	900	1.360	437.075	438.425	745710.843	5839512.554	279.52	PROVIDE STEP RONS. REFER TO SD-P-1
E19S	SEP	900	900	1.297	437.589	438.886	745744.442	5839523.116	99.52	PROVIDE STEP RONS. REFER TO SD-P-1
E20	SEP	900	900	2.229	436.328	438.857	745718.343	5839532.885	9.52	PROVIDE STEP RONS. REFER TO SD-P-1
E21	SEP	900	900	2.120	436.457	438.577	745727.013	5839531.376	189.52	PROVIDE STEP RONS. REFER TO SD-P-1
E22	SEP	900	900	2.553	436.588	439.141	745737.213	5839564.134	189.52	PROVIDE LADDER. REFER TO SD-P-1
E22a	EP	-	-	-	-	-	745733.571	5839589.080	9.52	REFER TO SD-P-1
E22-1	SEP	900	900	2.612	436.782	439.394	745724.044	5839565.443	9.52	PROVIDE LADDER. REFER TO SD-P-1
E22-2	JP	900	600	0.986	436.990	437.956	745897.000	5839572.089	99.52	REFER TO SD-P-1
E22-2a	EP	-	-	-	-	-	745897.343	5839574.060	99.52	REFER TO SD-P-1

PT	TYPE	PT DIMENSIONS			PT ELEVATIONS		PT LOCATION		FACE BRG	COMMENTS
No.		L	W	D	INVERT	TOP	EASTING	NORTHING	DEG MIN	
E100	EW	900	900	-	430.648	432.880	74524.883	5839560.206	216.44	REFER TO VIROADS SD 1921
E101	JP	900	900	2.137	430.723	432.880	74521.826	5839550.634	99.52	PROVIDE STEP RONS. REFER TO SD-P-1
E102	JP	900	900	1.337	431.133	432.530	74530.123	5839539.433	99.52	PROVIDE STEP RONS. REFER TO SD-P-1
E103	JP	900	900	1.307	432.201	433.688	74536.692	5839528.377	99.52	PROVIDE STEP RONS. REFER TO SD-P-1
E104	JP	900	600	0.797	433.763	434.560	745447.464	5839519.656	99.52	REFER TO SD-P-1
E105	JP	900	600	1.139	434.283	435.402	745497.788	5839511.683	99.52	REFER TO SD-P-1
E106	JP	900	900	1.822	434.566	436.587	745597.924	5839501.135	99.52	PROVIDE STEP RONS. REFER TO SD-P-1
E107	JP	900	900	1.276	435.348	436.624	745629.435	5839489.193	99.52	PROVIDE STEP RONS. REFER TO SD-P-1
E108	JP	900	900	1.441	435.483	436.624	745638.311	5839487.703	99.52	REFER TO SD-P-1
E109	JP	900	600	0.916	436.790	437.706	745677.242	5839461.018	99.52	REFER TO SD-P-1
E110	JP	900	600	0.741	437.901	438.642	745728.428	5839471.855	99.52	REFER TO SD-P-1

NOTE: SETOUT POINTS ARE TO CENTRE OF BASE

NOTE: SETOUT POINTS ARE TO CENTRE OF BASE

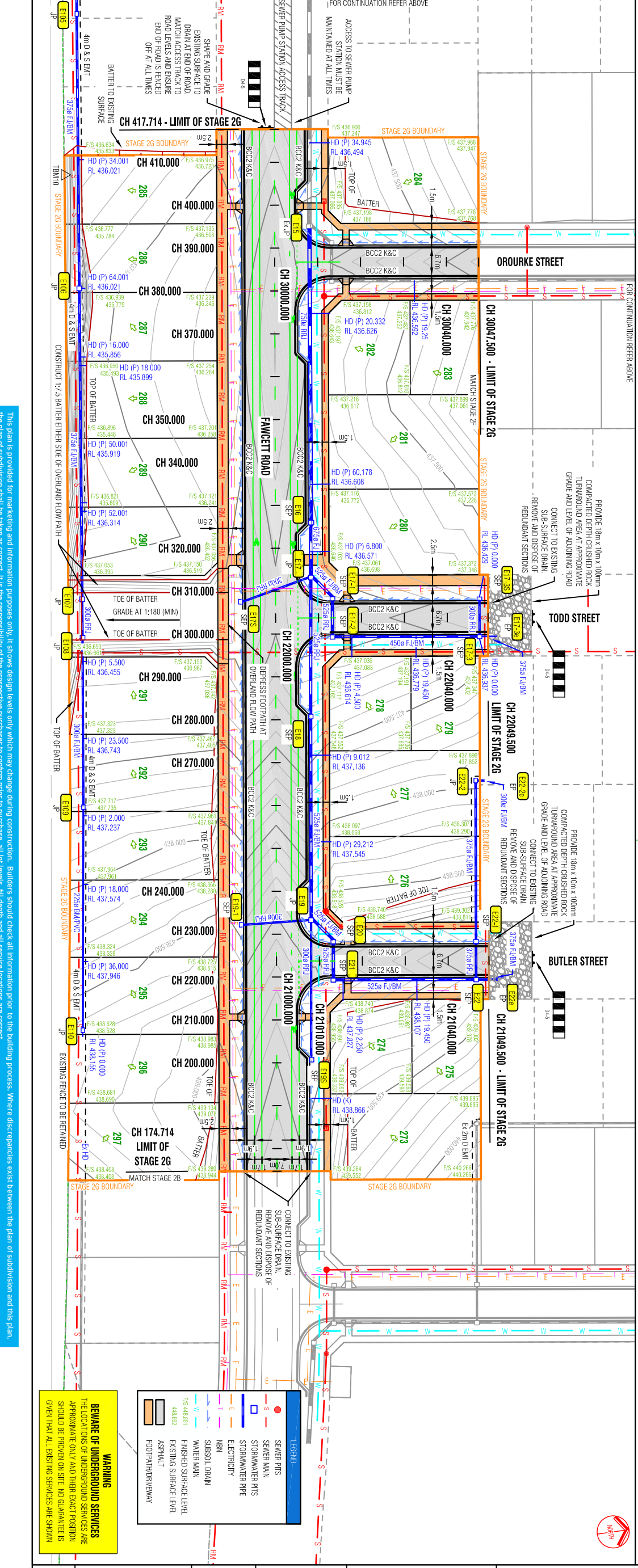
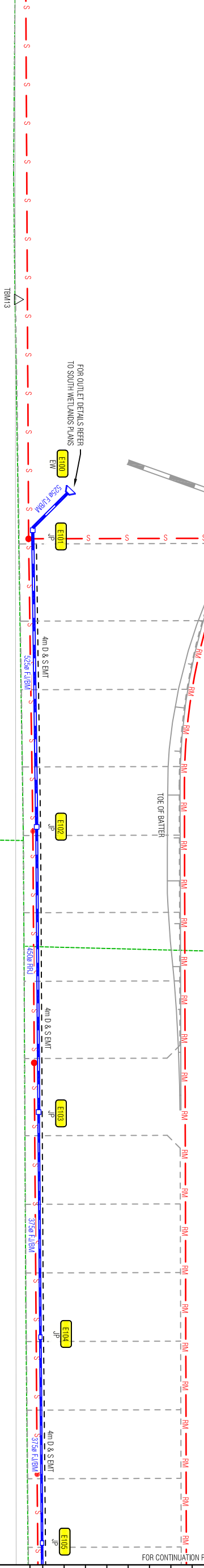

General Notes

- ALL HD CONNECTIONS WITH CHANGING TO CONNECT TO UNDERGROUND DRAINAGE
- RUNNING CHANGING OF HD TAKEN FROM NEXT DOWNSTREAM PT. ALL OTHER HD CONNECTIONS ARE TO KERB.
- SURFACE DRAINS TO OUTLET TO DRAINAGE PITS
- ROAD DIMENSIONS ARE SHOWN TO LP OF KERB AND CHANNEL
- RL SHOWN AT HOUSE DRAINS ARE INVERT OF PIPE AT 300mm FROM TITLE BOUNDARY/ASSESSMENT. HOUSE DRAINS MUST NOT BE HIGHER THAN LEVEL SHOWN.

SAFETY FIRST
SEEKS STARTS WITH YOU

180 Eleanor Drive, Lucas
Post Office Box 4226
Lucas, Victoria 3350
T: 03 5322 5999 F: 03 5322 5995

Project
LUCAS GRANGE ESTATE
RESIDENTIAL SUBDIVISION
STAGE 2G
LUCAS

Author:
Bakelrat City Council - (03) 5320 5500

Drawing Title:
DRAINAGE PLAN

Scale:
Scale (H): 1:500
Scale (V): 1:1000

Sheet Number:
5 of 14

Drawing Number:
LUG2G-CD-005

Revision:
A