

- General Notes
1. ALL HD CONNECTIONS WITH CHAINAGE TO CONNECT TO UNDERGROUND DRAINAGE
  2. LOCATIONS OF UNDERGROUND SERVICES ARE APPROXIMATE ONLY AND THEIR EXACT POSITION SHOULD BE PROVEN ON SITE. NO GUARANTEE IS GIVEN THAT ALL EXISTING SERVICES ARE SHOWN
  3. SUBSURFACE DRAINS TO OUTLET TO DRAINAGE PITS
  4. ROAD DIMENSIONS ARE SHOWN TO LIP OF KERB AND CHANNEL
  5. RL SHOWN AT HOUSE DRAINS ARE INVERT OF PIPE AT 300mm INSIDE TITLE BOUNDARY/EASEMENT. HOUSE DRAINS MUST NOT BE HIGHER THAN LEVEL SHOWN. UNLESS OTHERWISE NOTED.
  6. ALL DRAINAGE PIT LIDS TO BE CLASS "B" UNLESS OTHERWISE NOTED.
  7. DRAINAGE PIPES ARE TO BE RCP OR RIBBED POLYPROPYLENE PIPES (PP) AS APPROVED BY CITY OF BALLARAT.
  8. ALL DRAINAGE PIPES ARE TO BE INSTALLED IN ACCORDANCE WITH THE MANUFACTURERS SPECIFICATION.

**SAFETY FIRST**  
SAFETY STARTS WITH YOU!

Rev	Amendment	Initials	Date
D			
C	Lots 570 to 573 Rear of Lot Finished Surfaces Levels Amended	DG	15/08/24
B	Drainage Moved to Stage 3D. Blockout RL's Amended.	DG	23/01/24
A	Issued for Construction	DG	11/01/24

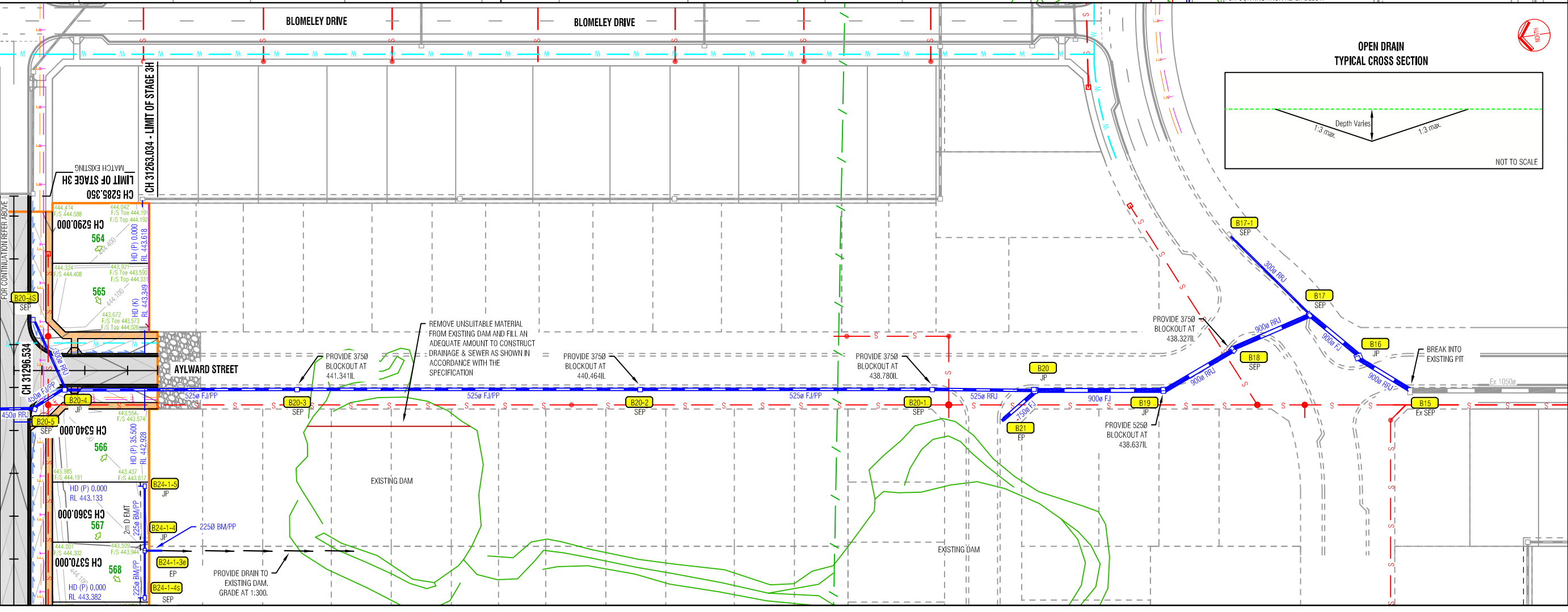

**Intega**

Post Office Box 4226  
Lucas, Victoria 3350  
T: 03 5322 5999 F: 03 5322 5995

Project  
**LUCAS GRANGE ESTATE RESIDENTIAL SUBDIVISION STAGE 3H LUCAS**

Authority  
Ballarat City Council - (03) 5320 5500

Drawing Title  
**DRAINAGE PLAN**

Status  
**APPROVED ISSUED FOR CONSTRUCTION**

Designer: D.Georgalas  
Checker: T.Oldaker  
Scale (A1): 1:500  
Scale (A3): 1:1000  
HQR 0 5 10 15 20 25  
VER

Sheet Number  
**4 of 17**

Drawing Number: **LUG3H-CD-004**  
Revision: **C**

This plan is provided for marketing and information purposes only, it shows design levels only which may change during construction. Builders should check all information prior to the building process. Where discrepancies exist between the plan of subdivision and this plan, the plan of subdivision shall be taken as correct. It is the responsibility of the prospective purchaser to confirm prior to purchase, all lot levels, fill depth and all service locations are correct.